

Check out the assembly video with this code

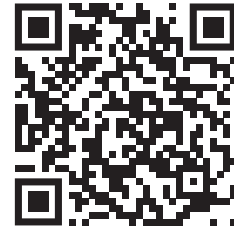

or go to www.youtube.com/watch?v=zcuevCq2Wsk&t=1s

DISPOSABLE, 2 PIECE FACE/SPLASH SHIELD ASSEMBLY INSTRUCTIONS



1 Align Head Strap with Clear Shield.

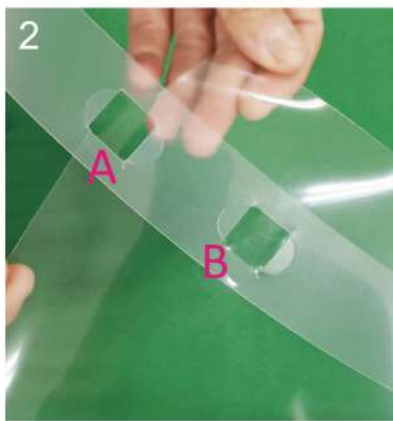

2 Insert and lock left-side Clear Shield tabs into left-side Locking Holes A and B.

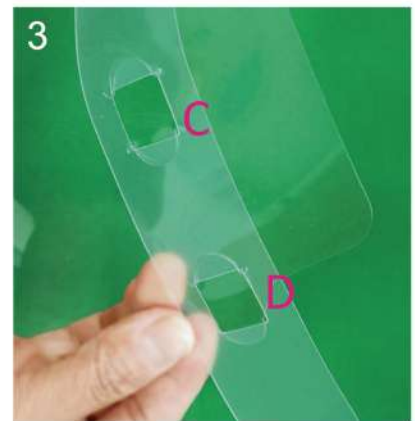

3 Do the same with right-side Clear Shield tabs and right-side Locking Holes C and D.

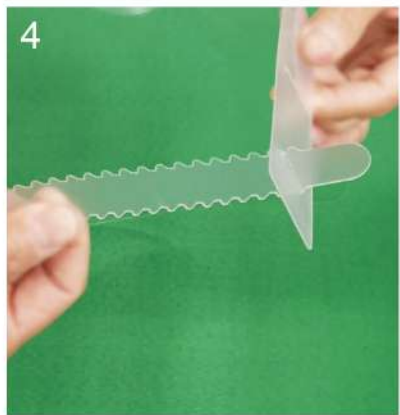

4 Circle the Head Strap (Clear Shield to outside) and insert Adjustable End into Outside Slot.



5 Once approximately sized, insert the Adjustable End into the Inside Slot.

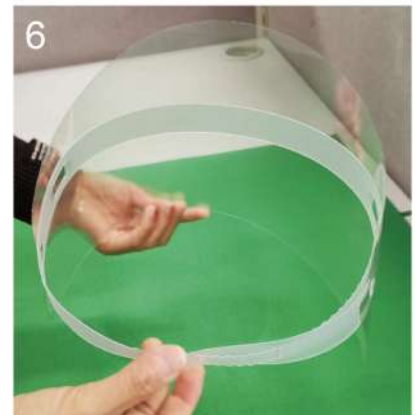

6 Assembly Complete. Fine-tune Adjustable End if required.



ClearBags®
be seen